

HTD63L TYPE

TYPE

HTD 63L

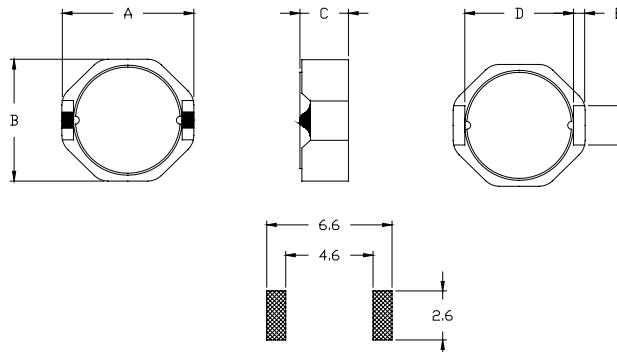

A: 6.8 MAX
B: 6.2 MAX
C: 3.0 MAX
D: 4.8 REF
E: 0.6 REF
F: 2.0 REF

SPECIFICATION

ITEM	L	DCR	IDC
HTD63L	(μH)	($\text{m}\Omega$)	MAX.(A)
1R0M	1.0 \pm 20%	11	3.59
1R5M	1.5 \pm 20%	13	2.93
2R2M	2.2 \pm 20%	16	2.42
3R6M	3.6 \pm 20%	21	1.89
4R7M	4.7 \pm 20%	27	1.66
6R2M	6.8 \pm 20%	32	1.45
100M	10 \pm 20%	49	1.14
120M	12 \pm 20%	52	1.04
150M	15 \pm 20%	62	0.93
180M	18 \pm 20%	74	0.85
220M	22 \pm 20%	95	0.77
270M	27 \pm 20%	120	0.70
330M	33 \pm 20%	140	0.63
390M	39 \pm 20%	150	0.58
470M	47 \pm 20%	185	0.53
560M	56 \pm 20%	220	0.48
680M	68 \pm 20%	270	0.44
820M	82 \pm 20%	330	0.40
101M	10 \pm 20%	415	0.36
151M	150 \pm 20%	616	0.31

M: \pm 20%

* Hong can design any part to your requirements with different inductance.

* All parameters as this content presented are subject to final specifications both sides confirmed.